

# Course Overview

## Menu of Courses – Level 3 Further Education

### Full Time Courses (16 - 18 years)

**T-LEVELS**  
THE NEXT LEVEL QUALIFICATION

**T-Level in Construction: Design, Surveying and Planning**

Find Out  
More



**BTEC Level 3 Extended Diploma in Construction & the Built Environment – 2 Years**

Find Out  
More



### Part Time Courses (Day Release)



**BTEC Extended Certificate in Construction, Civil Engineering or Building Services Engineering – Bridging Course to Higher Education – 1 Year**

Find Out  
More



**BTEC Diploma in Construction – 2 Years**

Find Out  
More



**BTEC Diploma in Civil Engineering – 2 Years**

Find Out  
More



**BTEC Diploma in Building Services Engineering – 2 Years**

Find Out  
More



## ADVANCED APPRENTICESHIPS – LEVEL 3



***Building Services Engineering Technician - ST0063***

**Find Out  
More**



***Civil Engineering Technician – ST0091***

**Find Out  
More**



***Construction Support Technician – ST0960***

**Find Out  
More**



***Digital Engineering Technician – ST0266***

**Find Out  
More**



***Transport Planning Technician – ST0336***

**Find Out  
More**



## Menu of Courses – Higher Education

### FULL TIME COURSES - HNC



***Higher National Certificate (HNC) in Construction Management – 1 Year***

**Find Out  
More**



***Higher National Certificate (HNC) in Civil Engineering – 1 Year***

**Find Out  
More**



## PART TIME COURSES – HNC – DAY RELEASE



**Higher National Certificate In Building Services Engineering – 1.5 Years**

**Find Out More**



**Higher National Certificate In Construction Management – 1.5 Years**

**Find Out More**



**Higher National Certificate In Civil Engineering – 1.5 Years**

**Find Out More**



**Higher National Certificate In Quantity Surveying – 1.5 Years**

**Find Out More**



## HIGHER APPRENTICESHIPS – LEVEL 4



**Building Services Engineering Technician – ST0041**

**Find Out More**



**Construction Site Engineering Technician – ST0046**

**Find Out More**



**Construction Design And Build Technician – ST0043**

**Find Out More**



**Construction Site Supervisor – ST0048**

**Find Out More**



**Construction Quantity Surveying Technician – ST0049**

**Find Out More**





# Menu of Courses - Degree Apprenticeships



**Level 5/6 Degree in Civil Engineering Site Management – Top up (LBU)**

**Find Out More**



**Construction Quantity Surveying Degree Apprenticeship**

**Find Out More**



# Menu of Courses – CAD & Revit Courses

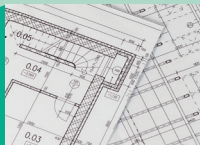

**2D CAD - Computer Aided Design Level 2 Award**

**Find Out More**



**2D CAD - Computer Aided Design Level 3 Award**

**Find Out More**

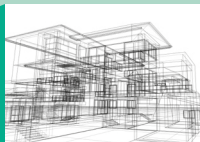

**3D CAD - Computer Aided Design Level 3 Award**

**Find Out More**



**AutoCAD® Essentials Course**

**Find Out More**



**Autodesk® Revit® Architecture Essentials**

**Find Out More**



**AutoCAD® Update Course**

**Find Out More**



**AutoCAD® Intermediate Course**

**Find Out More**



www.lcb.ac.uk

www

weare\_lcb



weare\_lcb



leedscollegebuilding







**AutoCAD® Starter Course**

**Find Out  
More**



**Autodesk® Revit® Architecture Template And Family  
Creation**

**Find Out  
More**



## **Additional Links**



**Prospectus & Course Guides**

**Find Out  
More**



**Apprenticeship Information For Employers**

**Find Out  
More**



**How To Apply**

**Find Out  
More**



**Finance For Part-Time Students**

**Find Out  
More**



**Financial Support For Higher Education**

**Find Out  
More**



www.lcb.ac.uk

www

weare\_lcb



weare\_lcb



leedscollegebuilding

